

NO.	DATE	DESCRIPTION
△		REVISIONS
△		DESIGN CLARIFICATION

DATE	12/28/2009
DRAWN	MC
CHECKED	VJD
SCALE	AS SHOWN
JOB NO.	208022.00
SHEET NUMBER	

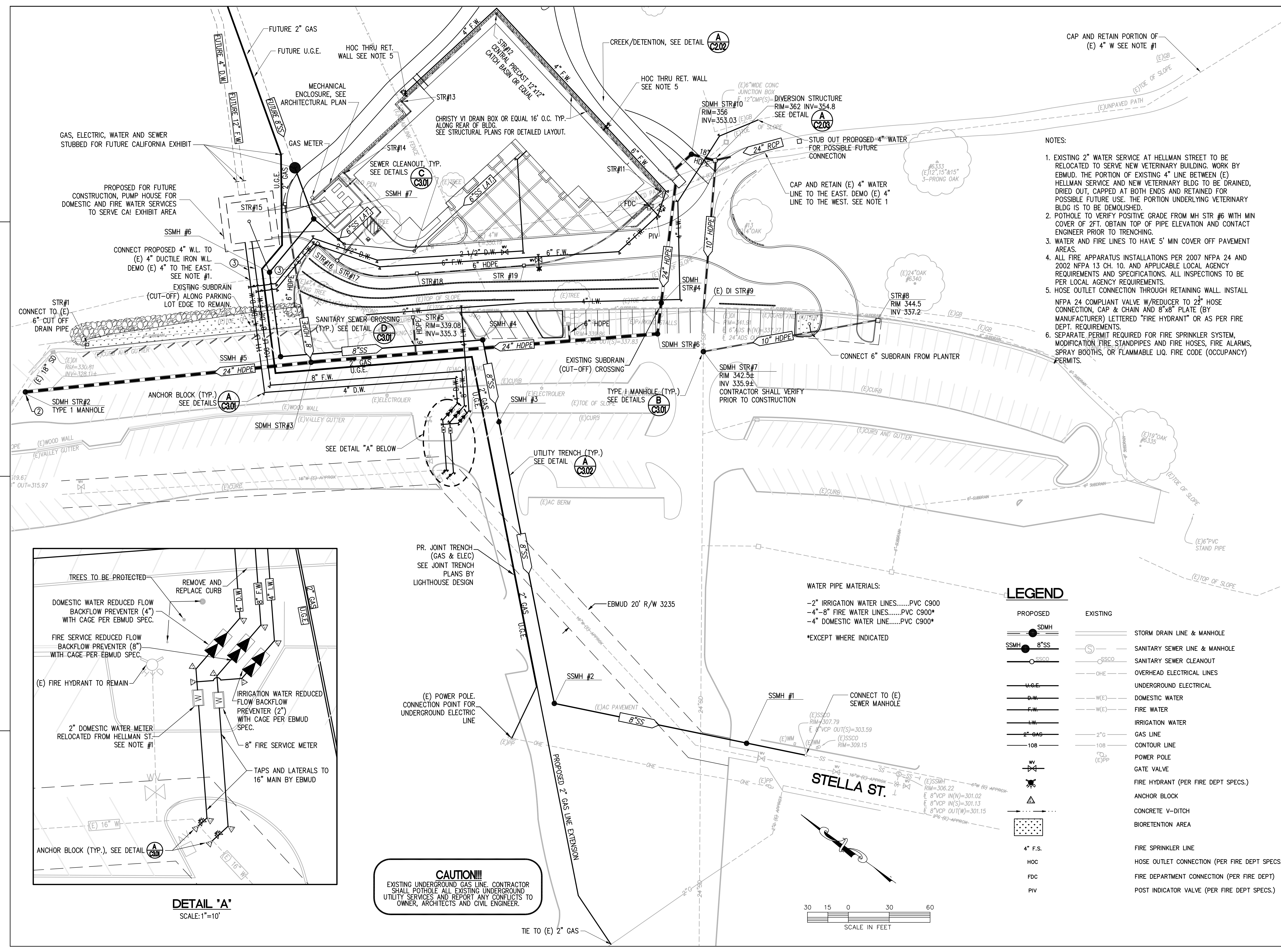

- NOTES:
- EXISTING 2" WATER SERVICE AT HELLMAN STREET TO BE RELOCATED TO SERVE NEW VETERINARY BUILDING. WORK BY EBMUD. THE PORTION OF EXISTING 4" LINE BETWEEN (E) HELLMAN SERVICE AND NEW VETERINARY BLDG TO BE DRAINED, DRIED OUT, CAPPED AT BOTH ENDS AND RETAINED FOR POSSIBLE FUTURE USE. THE PORTION UNDERLYING VETERINARY BLDG IS TO BE DEMOLISHED.
  - POTHOLE TO VERIFY POSITIVE GRADE FROM MH STR #6 WITH MIN COVER OF 2FT. OBTAIN TOP OF PIPE ELEVATION AND CONTACT ENGINEER PRIOR TO TRENCHING.
  - WATER AND FIRE LINES TO HAVE 5' MIN COVER OFF PAVEMENT AREAS.
  - ALL FIRE APPARATUS INSTALLATIONS PER 2007 NFPA 24 AND 2002 NFPA 13 CH. 10. AND APPLICABLE LOCAL AGENCY REQUIREMENTS AND SPECIFICATIONS. ALL INSPECTIONS TO BE PER LOCAL AGENCY REQUIREMENTS.
  - HOSE OUTLET CONNECTION THROUGH RETAINING WALL. INSTALL NFPA 24 COMPLIANT VALVE W/REDUCER TO 2 1/2" HOSE CONNECTION, CAP & CHAIN AND 8"x8" PLATE (BY MANUFACTURER) LETTERED "FIRE HYDRANT" OR AS PER FIRE DEPT. REQUIREMENTS.
  - SEPARATE PERMIT REQUIRED FOR FIRE SPRINKLER SYSTEM, MODIFICATION FIRE STANDPIPES AND FIRE HOSES, FIRE ALARMS, SPRAY BOOTHS, OR FLAMMABLE LIQ. FIRE CODE (OCCUPANCY) PERMITS.

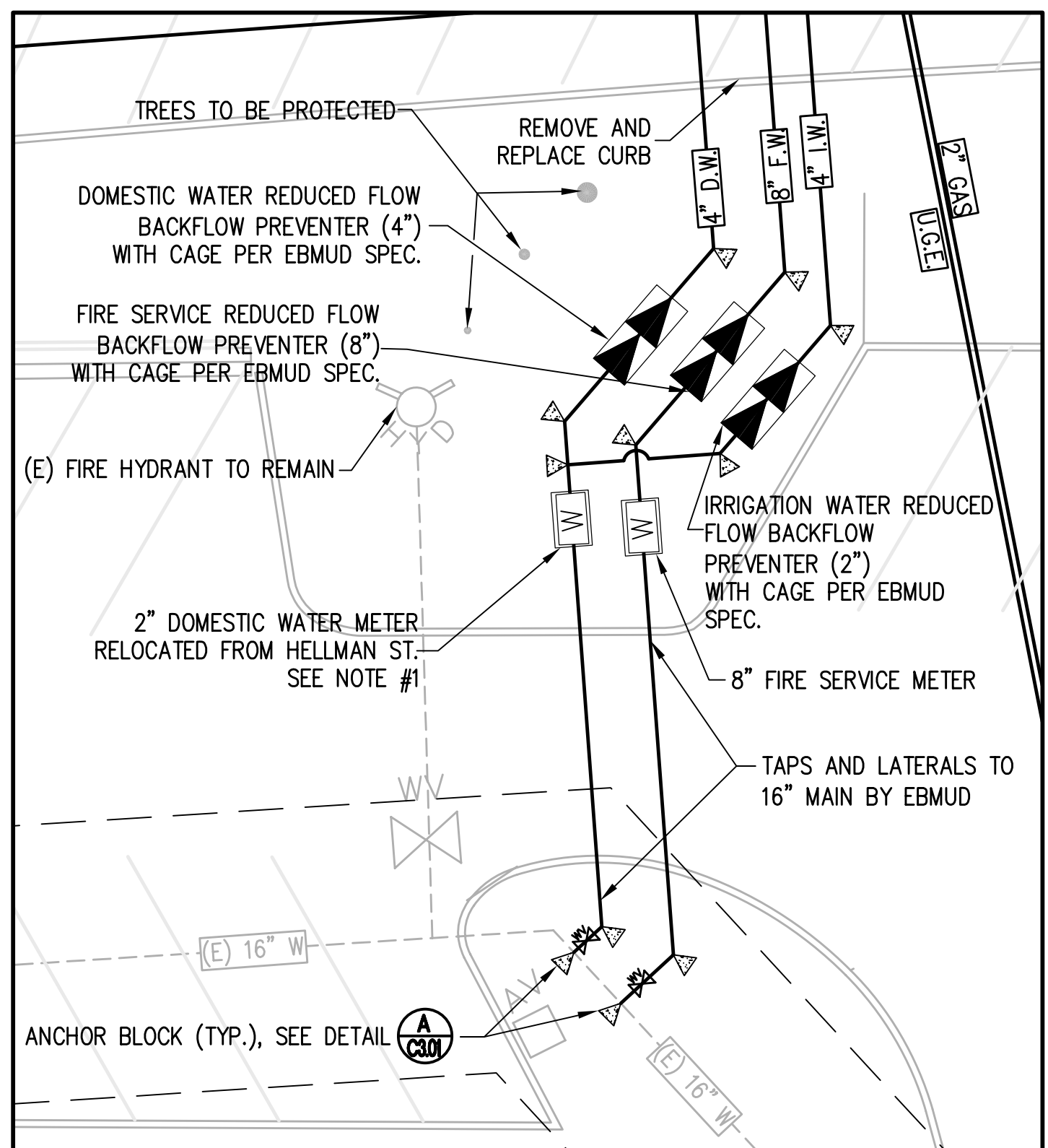

**DETAIL 'A'**  
SCALE: 1"=10'

**CAUTION!!!**  
EXISTING UNDERGROUND GAS LINE. CONTRACTOR SHALL POTHOLE ALL EXISTING UNDERGROUND UTILITY SERVICES AND REPORT ANY CONFLICTS TO OWNER, ARCHITECTS AND CIVIL ENGINEER.

WATER PIPE MATERIALS:  
-2" IRRIGATION WATER LINES.....PVC C900  
-4"-8" FIRE WATER LINES.....PVC C900\*  
-4" DOMESTIC WATER LINE.....PVC C900\*  
\*EXCEPT WHERE INDICATED

**LEGEND**

PROPOSED	EXISTING	DESCRIPTION
●	●	SDMH
●	●	SSMH 8"SS
○	○	SSCO
—	—	U.G.E.
—	—	D.W.
—	—	F.W.
—	—	I.W.
—	—	2" GAS
—	—	108
—	—	POWER POLE
—	—	GATE VALVE
—	—	FIRE HYDRANT (PER FIRE DEPT SPECS.)
—	—	ANCHOR BLOCK
—	—	CONCRETE V-DITCH
—	—	BIORETENTION AREA
—	—	4" F.S.
—	—	HOC
—	—	FDC
—	—	PIV
—	—	STORM DRAIN LINE & MANHOLE
—	—	SANITARY SEWER LINE & MANHOLE
—	—	SANITARY SEWER CLEANOUT
—	—	OVERHEAD ELECTRICAL LINES
—	—	UNDERGROUND ELECTRICAL
—	—	DOMESTIC WATER
—	—	FIRE WATER
—	—	IRRIGATION WATER
—	—	GAS LINE
—	—	CONTOUR LINE
—	—	POWER POLE
—	—	FIRE SPRINKLER LINE
—	—	HOSE OUTLET CONNECTION (PER FIRE DEPT SPECS.)
—	—	FIRE DEPARTMENT CONNECTION (PER FIRE DEPT)
—	—	POST INDICATOR VALVE (PER FIRE DEPT SPECS.)

